

2 Garden Bed Preparation Detail

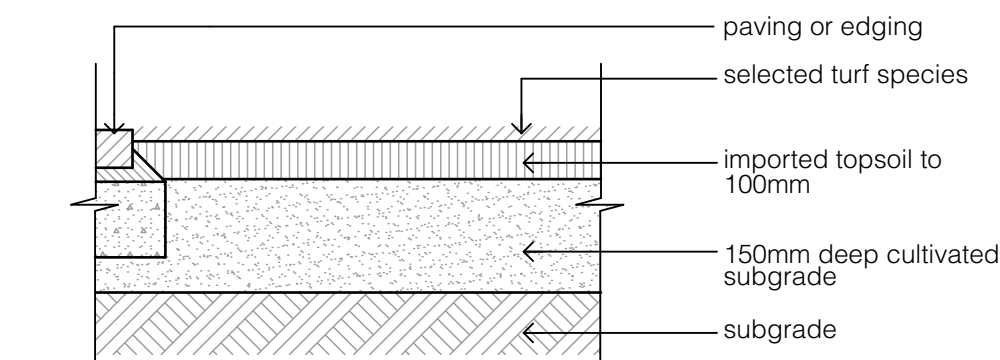

3 Turf Preparation Detail

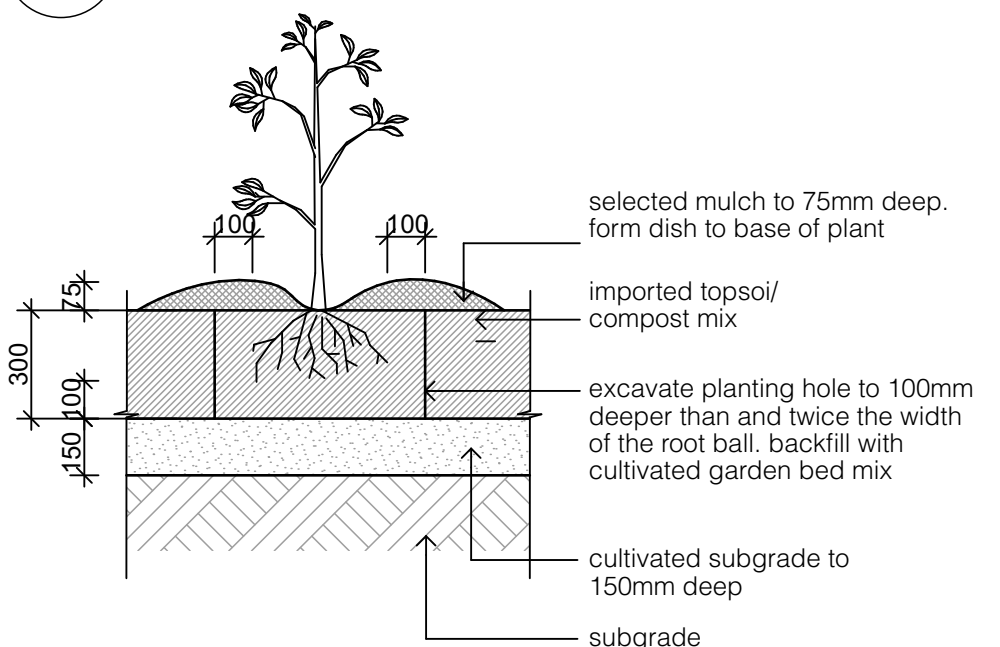

4 Garden Bed Planting Detail

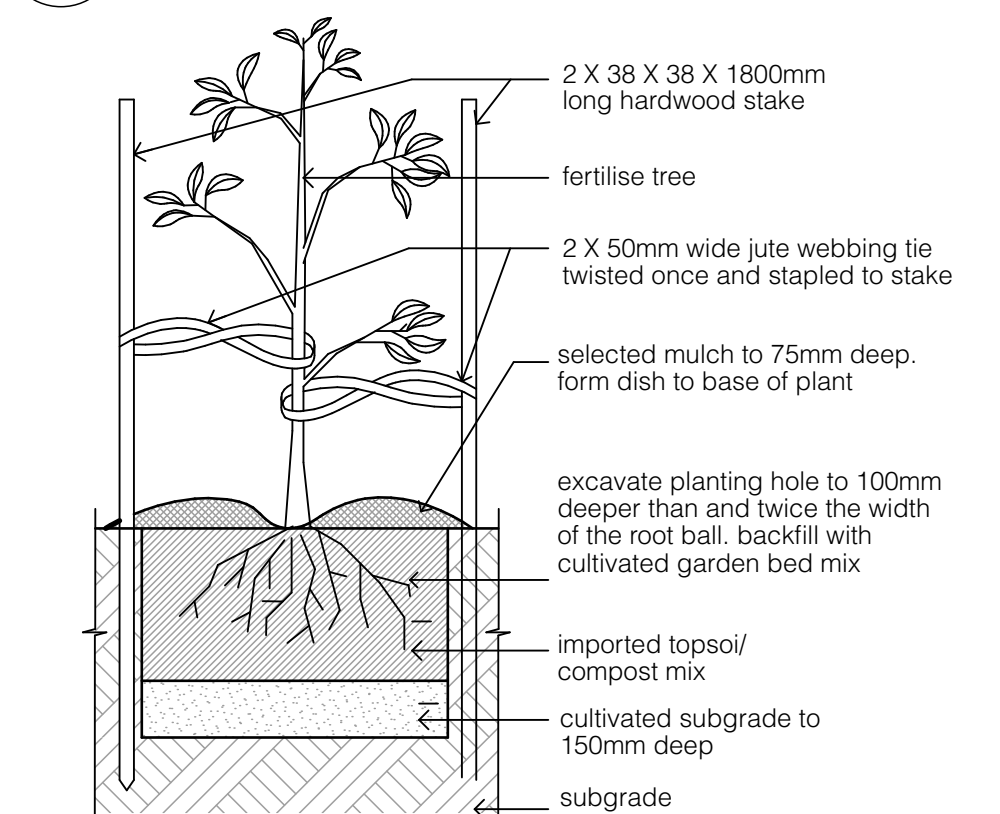

5 15-45L Tree Planting Detail

Shrubs			
Cal	Correa alba	White Correa	1.5m
Cep	Camellia 'Early Pearly'	Camellia	2.0m
Lch	Loropetalum chinense var. Rubrum	Chinese Fringe Flower	1.5m
Mpa	Murraya paniculata	Orange Jessamine	3.0m
Pmm	Pittosporum 'Miss Muffet'	'Miss Muffet'	1.0m
Pxa	Philodendron 'Xanadu'	'Xanadu'	1.0m
Rop	Raphiolepis 'Oriental Pearl'	Indian Hawthorne	1.0m
Sch	Santolina chamaecyparissus	Lavender Cotton	0.5m
Vel	Viburnum odoratissimum 'Emerald Lustre'	Emerald Lustre	4.0m
Wab	Westringia 'Aussie Box'	Coastal Rosemary	0.6m

Groundcovers, Grasses and Feature Plants			
Aau	Asplenium australasicum	Birds Nest Fern	1.0m
Ac	Arthropodium cirratum	NZ Rock Lily	0.9m
Arv	Anigozanthus 'Ruby Velvet'	Kangaroo Paw	1.0m
Avr	Agave victoriae-reginae	Queen Victoria Agave	0.3m
Bca	Blechnum cartilagineum	Gristle Fern	0.7m
Cov	Crassula ovata 'Undulatum'	Jade Plant	0.5m
Cte	Chondropetalum tectorum	Small Cape Rush	1.0m
Dex	Doodia aspera	Rasp Fern	0.5m
Das	Doryanthes excelsa	Gymea Lily	1.2m
Dre	Dichondra repens	Kidney Weed	0.1m
Dro	Diets robinsoniana	Lord Howe Is Lily	0.7m
Dsf	Dichondra 'Silver Falls'	Silver Falls Kidney Weed	0.1m
Fgl	Festuca glauca	Blue Fescue	0.3m
Kcs	Kalanchoe orygalis 'Copper Spoons'	Copper Spoons	0.5m
Kss	Kalanchoe bracteata 'Silver Spoons'	Silver Spoons	0.5m
Ljr	Liriope 'Just Right'	Lily Turf	0.5m
Lt	Lomandra longifolia 'Tanika'	Dwarf Mat Rush	0.6m
Myp	Myoporum parvifolium	Creeping Boobiala	0.1m
Ppo	Poa poiformis 'Kingsdale'	Kingsdale	0.4m

1 Landscape Plan 1:100

Legend		(external work / site plan)	
ex.RL00.00 → existing levels		RL00.00 → proposed levels	
ex.contours & banking line		existing trees to be retained	
ac	air conditioner condenser	ac	accessible
adcc	ageing, disability & home care	adcc	access panel
ap	balustrade (type)	bal(1)	broom finished concrete
bfc	brick on edge	boe	brick on edge
bol	bollard	bol	bollard
cl	clothes line	col	column
col	downpipe	col	downpipe
dp	doorpost	dp	doorpost
ex	existing	ex	existing
fb(1)	facebrick work (type)	fb(1)	facebrick work (type)
ft(1)	fence (type)	ft(1)	fence (type)
gb	garbage bin	gb	garbage bin
gt	gate	gt	gate
gtd	grated drain	gtd	grated drain
hr(1)	handrail (type)	hr(1)	handrail (type)
ht	hose tap	ht	hose tap
hwu	hot water unit	hwu	hot water unit
hydrant	hydrant	hydrant	hydrant
kr	kerb ramp	kr	kerb ramp
lb	letter box	lb	letter box
off	off form concrete	off	off form concrete
pp	power pole	pp	power pole
rw(1)	retaining wall (type)	rw(1)	retaining wall (type)
sfc	steel float concrete	sfc	steel float concrete
swp	storm water pit	swp	storm water pit
tf	trowel finished concrete	tf	trowel finished concrete
tgsl	tactile ground surface indicator	tgsl	tactile ground surface indicator
tow	top of wall	tow	top of wall
wfc	wood float concrete	wfc	wood float concrete

planting areas ensure that the mass planting areas have been excavated to 300mm below finished levels. rip to a further depth of 150mm. supply and install 300mm soil mix. soil mix to comprise of one part approved compost to three parts top soil. topsoil shall be either imported topsoil or stockpiled site topsoil (if suitable ie. no clay). install 75mm of selected mulch. mulch to be non toxic shredded pine flakes (25 x 4 x 2mm)

turf excavate/grade areas to be turfed to 120mm below the required finished levels. do not excavate with 1500mm of any existing tree to be retained. ensure that all of the surface water runoff is to be directed towards the inlet pits. kerbs etc. ad away from buildings. ensure that no pooling or ponding will occur. rip subgrade to 150mm deep. install 100mm depth of imported topsoil. just prior to spreading turf, spread shireys no. 17 lawn fertiliser over the topsoil at the recommended rate. lay Sir Walter Buffalo turf rolls closely butted. fill any small gaps with topsoil. water thoroughly.

note maintenance: all landscape works are to be maintained for a period of six months from the date of completion. this includes all watering, weeding, spraying and remedial necessary to achieve vigorous growth. any defects which arise during this period are to be rectified immediately. any plants or areas of turf which fall during this period are to be replaced at no additional cost.

plant schedule

code	botanical name	common name	mature height	pot size	stake
Trees					
Can	Cupaniopsis anacardioides	Tuckeroo	8.0m	35L	yes
Eu	Elaeocarpus eumundii	Smooth-leaved Quandong	8.0m	45L	yes
Lch	Lagerstroemia indica 'Natchez'	Crepe Myrtle	8.0m	45L	yes
Lis	Lagerstroemia indica 'Sioux'	Crepe Myrtle	4.0m	45L	yes
Lit	Lagerstroemia indica 'Tuscarora'	Crepe Myrtle	6.0m	45L	yes
Mlg	Magnolia 'Little Gem'	Little Gem Magnolia	4.0m	45L	yes
Til	Tristania laurina 'Luscious'	Water Gum	9.0m	45L	yes

Stanton Dahl Architects Pty Limited ABN 12 002 261 308
PO Box 833, Epping, NSW 1710, Australia
Tel +61 2 8876 5300 Fax +61 2 9868 2624
www.stantondahl.com.au

All dimensions to be verified on site and any discrepancies referred to architect for determination. figured dimensions to take precedence over scaled dimensions.

This design including its associated drawings, images, etc. is the intellectual property of stanton dahl & associates pty limited and must not be referenced, copied or used without written permission of stanton dahl & associates pty limited.

Rev	Issue	Date
P1	Preliminary DA Issue	21.03.19
P2	Preliminary DA Issue	25.03.19
1	DA Issue	26.03.19
2	Revised DA Issue	17.04.19
3	Revised DA Issue	09.05.19
4	Revised DA Issue	11.12.19

botanique design
PO Box 462 Berry NSW 2535
abn 24 254 273 270

Miss Melissa McGeorge
m. 0404 887 620
e. melissa@inviewdesign.com.au

AILD Member No. 676

Architecture
Project management
Interior design

stanton dahl architects

MONO

Family & Community Services
Land & Housing Corporation

Mono Constructions

Residential Apartment Building (x28)

24-28 Viccliffe Avenue,
Campsie, NSW

Drawn: mm
Checked: jpk
Plot date: 12/12/19

Scale: 1:100 as noted @ A1

Project No:
2370.18

Drawing No:
L01

Revision#:
4

Landscape Plan